





CONTENTS

02 AOKE

03 Mission/vision

05 Green, health & comfort

06 Timeline

09 Certifications

10 Products

51 Table tops

55 Accessories

73 Seating series

80 Product specifications

84 Product dimensions



Ningbo AOKE

- » Founded in 2012
- » 45.000 square meter factory
- » Approx. 500 employees
- » ISO certified
- » 3 automated assembly lines, 12 laser-cutting machines, 10 robot welding machines, 2 powder coating lines
- » Over 30 engineers and technicians



AOKE EUROPE

- » Founded in 2016
- » 1.800 square meter warehouse currently expanding to 5.500 square meter
- » 600 square meter office space and showroom
- » Most products have a 5 year warranty period
- » Exporting towards 28 European countries

MISSION

At AOKE we develop and provide our customers with high-quality, ergonomic office equipment in order to promote the well-being and productivity of office employees. Supported by our high service level and fast delivery times we offer an excellent experience for our customer.

VISION

While being a leader in sustainability we promote a healthy office environment on a global scale with high quality equipment. We are anticipating on the latest trends in the industry by focussing and investing in R&D. We keep replacing old fashioned office equipment by our modern, ergonomic products, so employees will be happy to come to work every morning.





GREEN, HEALTH & COMFORT

At AOKE we have a strict commitment towards the environment, health and comfort.

AOKE is managed in accordance with ISO:14001, this means preventing environmental pollution. We make use of environmental friendly resources in our products. Moreover, we control the risks resulting from our organisational activities. So we won't damage the earth when providing a healthier workplace for you!



- 🌱 **AOKE** is focussed on health by ergonomic desks and chairs. We want you to stay healthy and keep the best body positions throughout your day. By working with ergonomic desks and chairs your body and mind will stay healthy, which will lead to a higher productivity. key here is an alternation of good working postures, a variety of tasks and sufficient breaks from sitting. AOKE for a healthy workday!
- 🌱 **AOKE** focusses on both health as comfort, it is important to have a comfortable office chair to provide you with the peace you deserve. AOKE office furniture will let you enjoy your breaks even more! Comfort comes from quality, at AOKE we only deliver the most high-quality office furniture for you!

TIMELINE AOKE EUROPE

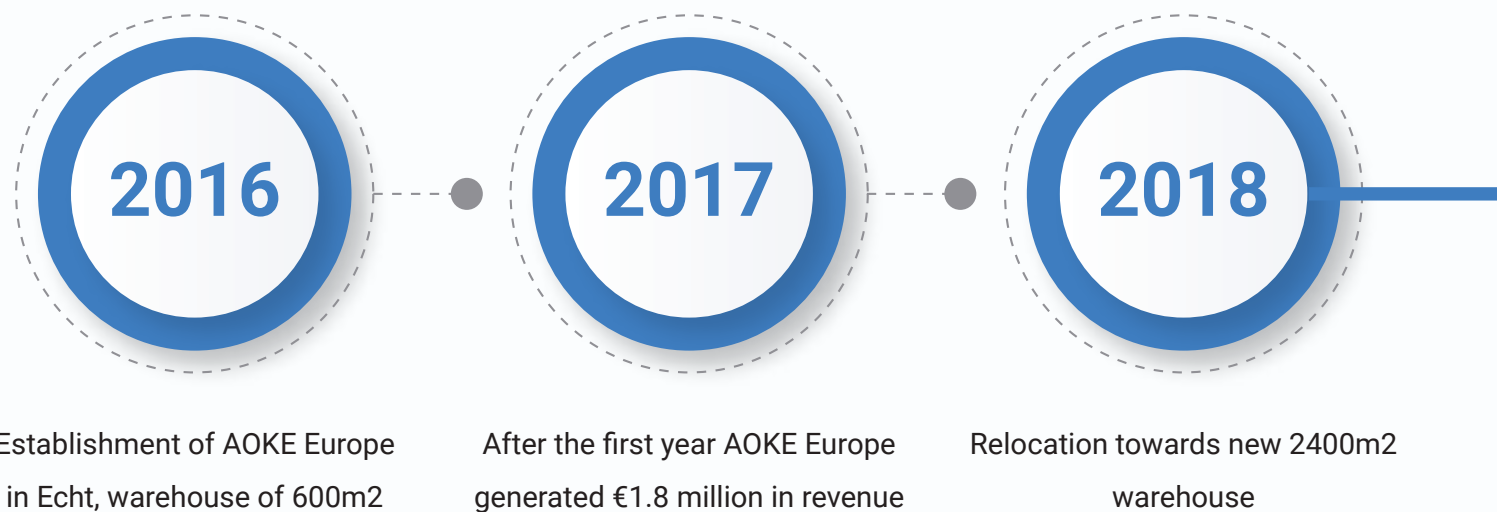

2019

Revenue growth towards €8.3
million revenue

2021

With an incredible CAGR of 57,5%
over the last 5 years, AOKE
Europe grew to €17.2
million revenue

2022

Relocation towards new 5500m2
warehouse



CERTIFICATION

At AOKE Europe we strive to provide you with the best quality office furniture, therefore we are constantly optimizing and improving our processes. The following certificates apply to our organisation.

ISO 9001

With an ISO 9001 certificate we show our customers that our processes meet international standards and attach great importance to continuous improvement of our processes.



CE

Our CE certification is an key indication our products comply with the legislation of the European Union.

NEN EN527

The NEN EN527 Certification specifies our high-quality products comply with safety, strength and durability requirements for work tables and desks used for computer and office tasks.



ROHS

ROHS stands for Restrictions of Hazardous Substances. At AOKE Europe we comply with the regulations regarding restricting the use of hazardous substances in our electronic equipment.



NEN EN1335

A European standard that specifies dimensions, adjustment possibilities and corresponding adjustment ranges. AOKE provides these standards so our office chairs are suitable for the majority of the European population.



SINGLE MOTOR SERIES

EASY UP — PAGE 12 / 13

DUAL MOTOR SERIES

SMART — PAGE 14 / 15

CUBIC — PAGE 16 / 17

PRESTIGE — PAGE 18 / 19

FLEX — PAGE 20 / 21

CIRCLE — PAGE 22 / 23

DUAL MOTOR BENCH SERIES

SMART DUO — PAGE 24 / 25

FLEX DUO — PAGE 25 / 26

TRIPLE MOTOR SERIES

EDGE — PAGE 27 / 28

TRIO — PAGE 29 / 30

MEET — PAGE 31 / 32

QUADRUPLE MOTOR SERIES

BLOCK — PAGE 33 / 34



EASY UP

SKU: AK02YJYT-TY-A-F

Single motor series

■ For product dimensions see page 84



For assembly videos and instructions

SCAN ME



View our range of table tops at page 51

Important product information & main specifications

Adjustable range height in mm.	: 690 - 1150
Adjustable range frame size in mm.	: 1075 - 1720
Max. lifting capacity	: 100 Kg
Warranty period	: 5 years
Available colours	: Aluminium RAL9006 : Black RAL9005 : White RAL9010
Gross packaging weight	: 29,6 Kg

■ For more specifications and comparison see page 80

Recommended accessories



Single tube



Cable tray 80



Power outlet

■ For more interesting accessories see page 55



SMART

SKU: AK2YJYT-TYZB3-A

Dual motor series

■ For product dimensions see page 84



For assembly videos and instructions

SCAN ME



[View our range of table tops at page 51](#)

Important product information & main specifications

Adjustable range height in mm.	: 625 - 1275
Adjustable range frame size in mm.	: 1075 - 1800
Max. lifting capacity	: 120 Kg
Warranty period	: 5 years
Available colours	: Aluminium RAL9006 : Black RAL9005 : White RAL9010
Gross packaging weight	: 31,5 Kg

■ For more specifications and comparison see page 80

Recommended accessories



Single tube



Cable tray 80



Power outlet

■ For more interesting accessories see page 55



CUBIC

AK2YJYT-TYZF3-A
Dual motor series

■ For product dimensions see page 84

For assembly videos and instructions



SCAN ME



View our range of table tops at page 51

Important product information & main specifications

- Adjustable range height in mm. : 625 - 1275
- Adjustable range frame size in mm. : 1075 - 1800
- Max. lifting capacity : 120 Kg
- Warranty period : 5 years
- Available colours : Aluminium RAL9006
- : Black RAL9005
- : White RAL9010
- Gross packaging weight : 32,5 Kg

Recommended accessories



Single tube



Cable tray 80



Power outlet

■ For more specifications and comparison see page 80

■ For more interesting accessories see page 55

Optional: also available with brackets of 900mm, this will provide you with the possibility to transform the Cubic desk into a small meeting table.



LITTLE

SKU: AK2YJYT-TYZF2-M02

Dual motor series

■ For product dimensions see page 84



For assembly videos and instructions



[View our range of table tops at page 51](#)

Important product information & main specifications

Adjustable range height in mm.	: 690 - 1150
Adjustable range frame size in mm.	: 700 – 1100
Max. lifting capacity	: 120 Kg
Warranty period	: 5 years
Available colours	: Aluminium RAL9006 : Black RAL9005 : White RAL9010

Recommended accessories



Single tube



Cable tray 80



Power outlet

■ For more specifications and comparison see page 80

■ For more interesting accessories see page 55



PRESTIGE

AK2YJYT-YDZF3-HE
Dual motor series

■ For product dimensions see page 84



For assembly videos and instructions

SCAN ME



View our range of table tops at page 51

Important product information & main specifications

- Including Bluetooth mover
 - Adjustable range height in mm. : 625 - 1275
 - Adjustable range frame size in mm. : 1075 - 1800
 - Max. lifting capacity : 120 Kg
 - Warranty period : 5 years
 - Available colours : Aluminium RAL9006
 - : Black RAL9005
 - : White RAL9010
 - Gross packaging weight : 34,5 Kg
- For more specifications and comparison see page 80

Recommended accessories



Single tube Cable tray 80 Power outlet

■ For more interesting accessories see page 55



FLEX

AK2YJYT-YZB3-BM
Dual motor series

■ For product dimensions see page 84



For assembly videos and instructions

SCAN ME



View our range of table tops at page 51

Important product information & main specifications

Adjustable range height in mm.	: 625 - 1275
Adjustable range frame size in mm.	: 1075 - 1800
Max. lifting capacity	: 80 Kg
Warranty period	: 2 years
Available colours	: Aluminium RAL9006 : Black RAL9005 : White RAL9010
Gross packaging weight	: 32,5 Kg

Recommended accessories



Single tube



Cable tray 80



Power outlet



CIRCLE

AK2YJYT-ZY3

Dual motor series

■ For product dimensions see page 84



SCAN ME

For assembly videos and instructions



View our range of table tops at page 51

Important product information & main specifications

Adjustable range height in mm.	: 625 - 1275
Adjustable range frame size in mm.	: 1075 - 1800
Max. lifting capacity	: 120 Kg
Warranty period	: 5 years
Available colours	: Aluminium RAL9006 : Black RAL9005 : White RAL9010
Gross packaging weight	: 30,5 Kg

Recommended accessories



Single tube



Cable tray 80



Power outlet

■ For more specifications and comparison see page 80

■ For more interesting accessories see page 55



HOME

SKU: AK-GT10-YZF2
Dual motor series

■ For product dimensions see page 84

For assembly videos and instructions



SCAN ME



Important product information & main specifications

Adjustable range height in mm.	: 710 – 1190
Table top size in mm.	: 1145 x 588
Max. lifting capacity	: 60 Kg
Warranty period	: 2 years
Available colours	: Black RAL9005 : White RAL9010
Including	: Built-in personal drawer : Built-in wireless charger : USB-A : USB-C

Recommended products

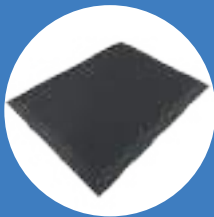

Anti-fatigue mat



Metal cabinet

■ For more specifications and comparison see page 80



SMART DUO

SKU: AK2 YJYT-TYZB3-A*2

Dual motor bench series

■ For product dimensions see page 84



For assembly videos and instructions

SCAN ME



View our range of table tops at page 51

Important product information & main specifications

Adjustable range height in mm.	: 625 - 1275
Adjustable range frame size in mm.	: 1075 - 1800
Max. lifting capacity	: 120 Kg per side
Warranty period	: 5 years
Available colours	: Aluminium RAL9006
	: Black RAL9005
	: White RAL9010
Gross packaging weight	: 72 Kg

Recommended accessories



Bench tube



Cable tray 80



Power outlet



Partition panel

■ For more specifications and comparison see page 80

■ For more interesting accessories see page 55



FLEX DUO

SKU: (AK2YJYT-YZB3-BM)*2

Dual motor bench series

■ For product dimensions see page 84



For assembly videos and instructions

SCAN ME



View our range of table tops at page 51

Important product information & main specifications

Adjustable range height in mm.	: 625 - 1275
Adjustable range frame size in mm.	: 1075 - 1800
Max. lifting capacity	: 80 Kg per side
Warranty period	: 2 years
Available colours	: Aluminium RAL9006
	: Black RAL9005
	: White RAL9010
Gross packaging weight	: 72 Kg

■ For more specifications and comparison see page 80

Recommended accessories



Bench tube



Cable tray 80



Power outlet



Partition panel

■ For more interesting accessories see page 55



EDGE

AK3YJYT-TYZF3-A.90

Triple motor series

■ For product dimensions see page 84



For assembly videos and instructions

SCAN ME



View our range of table tops at page 51

Important product information & main specifications

- Adjustable range height in mm. : 625 - 1275
- Adjustable range frame size in mm. : 1075 - 1800
- Max. lifting capacity : 150 Kg
- Warranty period : 5 years
- Available colours : Aluminium RAL9006
- : Black RAL9005
- : White RAL9010
- Gross packaging weight : 50 Kg

■ For more specifications and comparison see page 80

Recommended accessories



Single tube



Cable tray 80



Power outlet



Connecting Plate

■ For more interesting accessories see page 55



TRIO

AK3YJYT-TYZF3-A.120

Triple motor series

■ For product dimensions see page 84

For assembly videos and instructions



SCAN ME



View our range of table tops at page 51

Important product information & main specifications

Adjustable range height in mm.	: 625 - 1275
Adjustable range frame size in mm.	: 1100 - 1700 *2
Max. lifting capacity	: 150 Kg
Warranty period	: 5 years
Available colours	: Aluminium RAL9006
	: Black RAL9005
	: White RAL9010
Gross packaging weight	: 50 Kg

■ For more specifications and comparison see page 80

Recommended accessories



Single tube



Cable tray 80



Power outlet

■ For more interesting accessories see page 55



MEET

AK3YJYT-TYZF3-A.180

Triple motor series

■ For product dimensions see page 84



For assembly videos and instructions

SCAN ME



View our range of table tops at page 51

Important product information & main specifications

Adjustable range height in mm.	: 625 - 1275
Adjustable range frame size in mm.	: 2000 - 3000
Max. lifting capacity	: 150 Kg
Warranty period	: 5 years
Available colours	: Aluminium RAL9006 : Black RAL9005 : White RAL9010
Gross packaging weight	: 56 Kg

■ For more specifications and comparison see page 80

Recommended accessories



Single tube



Cable tray 80



Power outlet

■ For more interesting accessories see page 55



BLOCK

AK4YJYT-TYZF3
Quadruple motor series

■ For product dimensions see page 84



SCAN ME

For assembly videos and instructions



View our range of table tops at page 51

Important product information & main specifications

Adjustable range height in mm.	: 625 - 1275
Adjustable range frame size in mm.	: 860 – 1400
Max. lifting capacity	: 200 Kg
Warranty period	: 5 years
Available colours	: Aluminium RAL9006
	: Black RAL9005
	: White RAL9010
Gross packaging weight	: 30,5 Kg

■ For more specifications and comparison see page 80

Recommended accessories



Single tube



Cable tray 80



Power outlet

■ For more interesting accessories see page 55



MANUAL SERIES

INDIVIDUAL SERIES

HANDLE — PAGE 38 / 39

BENCH SERIES

HANDLE DUO — PAGE 40 / 41



HANDLE

AK2YJHT-Y-AJ-H
Manual series

■ For product dimensions see page 84



For assembly videos and instructions

SCAN ME



View our range of table tops at page 51

Important product information & main specifications

Adjustable range height in mm.	: 680 - 1130
Adjustable range frame size in mm.	: 1150 - 1800
Max. lifting capacity	: 80 Kg
Warranty period	: 5 years
Available colours	: Aluminium RAL9006 : Black RAL9005 : White RAL9010
Gross packaging weight	: 26,5 Kg

■ For more specifications and comparison see page 80

Recommended accessories



Single tube



Cable tray 80



Power outlet

■ For more interesting accessories see page 55



HANDLE DUO

SKU: AK2YJHT-Y-A-H*2

Manual bench series

■ For product dimensions see page 84



For assembly videos and instructions

SCAN ME



View our range of table tops at page 51

Important product information & main specifications

Adjustable range height in mm.	: 680 - 1130
Adjustable range frame size in mm.	: 1150 - 1800
Max. lifting capacity	: 80 Kg per side
Warranty period	: 5 years
Available colours	: Aluminium RAL9006
	: Black RAL9005
	: White RAL9010
Gross packaging weight	: 46 Kg

■ For more specifications and comparison see page 80

Recommended accessories



Single tube



Cable tray 80



Power outlet



Partition panel

■ For more interesting accessories see page 55



SCREW DESK SERIES

INDIVIDUAL SERIES

FIX

PAGE 91



FIX

SKU: AK03YJT-AJ
Screw desk series

■ For product dimensions see page 84



SCAN ME

For assembly videos and instructions



View our range of table tops at page 51

Important product information & main specifications

Static height range in mm.	: 575 – 855
Adjustable range frame size in mm.	: 1075 – 1800
Max. weight capacity	: 150
Warranty period	: 5 years
Available colours	: Aluminium RAL9006 : Black RAL9005 : White RAL9010
Gross packaging weight	: 150 Kg

■ For more specifications and comparison see page 80

L-shape screw desk

Add the L-shape add on to easily create a 90-degrees desk. Use SKU: AK03YJT-AJ.90 to order the additional box with the add-on as displayed in the picture below.



■ For more interesting accessories see page 55



TABLE TOP SERIES

To make the AOKE office experience complete we have a wide range of table tops. All colours can be ordered on request but for a quick delivery we have White, Logan oak, Robson, and Nature oak on stock.

When frames are combined with table tops we provide you with an even better price!

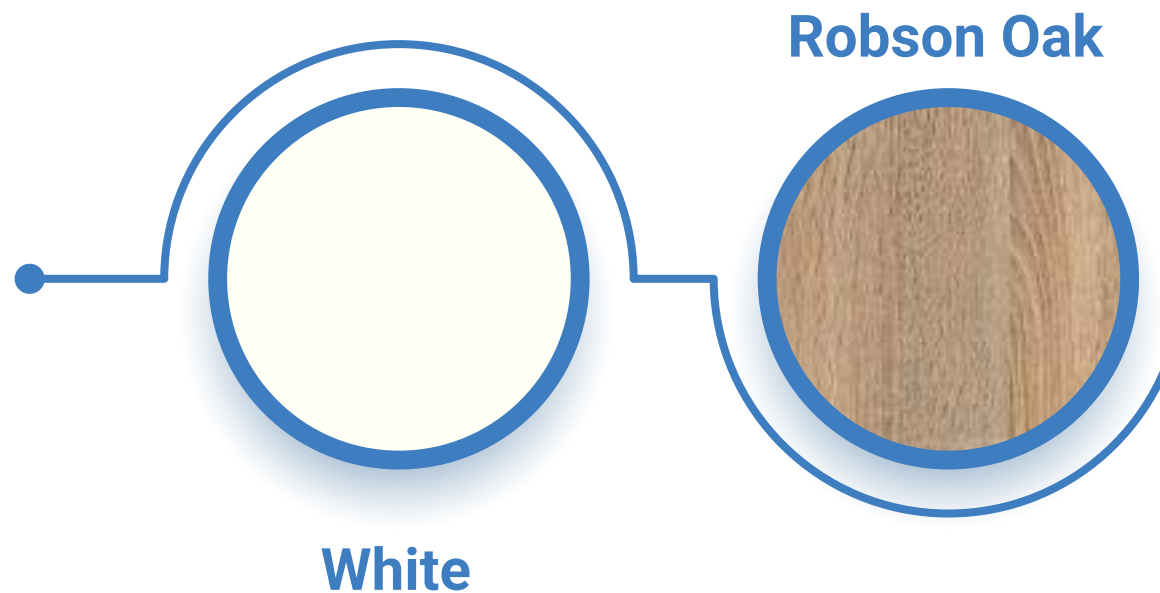

Beside our four on stock table top colours; White, Nature Oak, Logan oak, and Robson Oak. the lead time for other colours is 5+ / 8 - weeks.

Our standard sizes are:

- 1200 * 800 * 25 mm
- 1400 * 800 * 25 mm
- 1600 * 800 * 25 mm
- 1800 * 800 * 25 mm

- » All other sizes are available on request and have a lead time of at least 5 weeks.
- » All our table tops can be packed separately in a custom made carton packaging, for an additional €14,95. (SKU: TTP)
- » Better prices in combination with frames, for more information please contact us via mail or telephone.



Logan Oak



Nature Oak

**Connect set / SKU: CPT.S.BL**

To connect two table tops we have a connection plate set. This set can be screwed onto both table tops to make them connected as one piece.

Sizes : 35mm width x 150mm length x 3mm height





ACCESSORIES

The total package

At AOKE office we provide you with a complete range of office equipment. We offer a wide variety of ccessories to make your experience even better.

Our recommended accessories for every frame are:

- » **Cable trays;** to hide any loose cables inside the frame and make your office room clean and tidy
- » **Cable tubes;** to conceal cables going upwards to the socket plugs and computer screens
- » **Power outlet;** to provide laptop users with electricity or other electronic equipment

For our DUO set-ups (bench series) we also recommend the **partition panels** to create a sense of privacy.

Furthermore, AOKE Europe offers different other solutions, learn more in the upcoming pages.



Cable tube

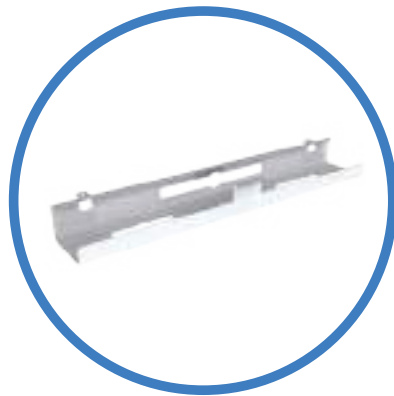

Metal cable tray



Partition panels



Socket plug



Cable tray / SKU: CM.800

This cable tray can be used to hide cables, the cable tray should be screwed to the table top. An absolute must to create the best office experience.

Length : 800 mm
Available in : Aluminium (RAL 9006)
: Black (RAL 9005)
: White (RAL 9010)

Single tube / SKU: CT.128.H / Bench tube / SKU: CT.132.B

This flexible cable tube allows you to conceal the cables running up to your computer screen or other electronic devices. It creates a more professional and clean office space and is therefore a must in your office. These come in single desk tubes or bench tubes.

Length : 1280 mm
Available in : Aluminium (RAL 9006)
: Black (RAL 9005)
: White (RAL 9010)





Power outlet / SKU AK-233C.BL

To provide you with easy electricity access on top of your desk . This socket plug even has a double USB port for your mobile devices.

Configuration : EU plug* 2+USB/A+C(38W)+2.5m length EU plug+mounting base

Input : AC 250V 10A

Output : AC 250V 10A

USB A output : 4.75V-5.35V/3A 8.55V-9.45V/2A 11.40 V-12.6V/ 1.5A

Type C output : 4.75V-5.35V/3A 8.55V-9.45V/2A 11.40V-12.V/ 1.67A

Part. Panels | SKU: PRP.160.80 & PRP.180.80

To provide office employees with more privacy our bench series should be delivered with a partition panel. Moreover, it creates a tidy office space. The use of partition panels is often experienced as very pleasant by its users. The panels are certified with a fire safety certificate. Interested in a different size or colour? Please contact us.

Sizes : 1600 * 800 * 30mm
1800 * 800 * 30mm

Available in : Grey
: Anthracite



WIRELESS CHARGER

SKU: AK-T13D

Suitable for office/cafe/restaurant etc., it can charge any device suitable for wireless charging through any non-metal surface, such as wood/plastic/granite etc.

Colour	: Black
Sticker colour	: Aluminium, Black, White
Material	: ABS
Wireless output	: 35W
Transmitting distance	: 15-30 mm







Bench connector | SKU: BCB

In order to conceal the cables when using a DUO frame we advise to use a bench connection beam. They can be linked to two benches with a magnet.

Sizes	: 10 (l) * 60 (w) mm
Material	: Steel
Available in	: Aluminium (RAL 9006) : Black (RAL 9005) : White (RAL 9010)

CPU holder | SKU: CPU.UNI

Our universal CPU holder is suitable for computers up to 14 kilos. It is being attached under the desk to allow the PC to be placed freely from the floor. This reduces the risk of dust and damage and the PC will be lifted with the table top.

Height adjustable	: 300 - 455 mm
Width adjustable	: 135 - 245 mm
Available in	: Aluminium (RAL 9006) : Black (RAL 9005) : White (RAL 9010)





Wireless charger | SKU: WP-W21

With the wireless charger WP-W21, you can charge your mobile devices extra fast without any cables. This charger supports wireless fast charging for all mobile devices that support this function.

Diameter	: 80mm
Hole Size	: 60mm
Thickness	: 12mm
Material	: plastic
Available in	: Black (RAL 9005)
	: White (RAL 9010)

Collision sensor | SKU: TCS1

With this anti-collision sensor you limit damage to the desk and/or devices nearby. Also the safety of the user will increase. As soon as the sensor detects that the desk is colliding with an obstacle, the desk stops moving.

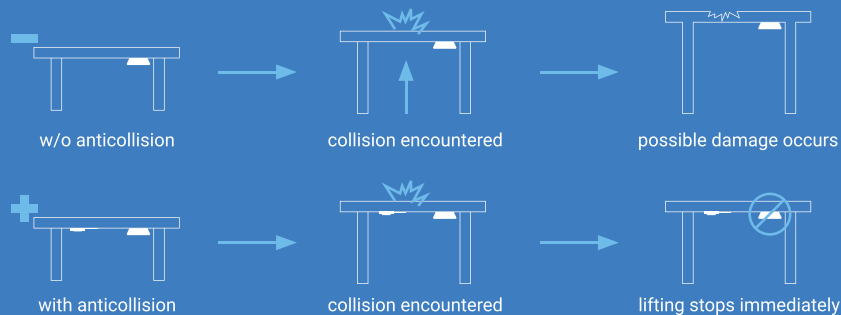



Fatigue mat / SKU: AFM.900.610

Standing at your desk can sometimes cause tired feet and legs. By using an anti-fatigue mat this phenomenon can be prevented. This makes it even more pleasant to use the sit/stand desk. In short, an important addition to your workplace!

Sizes	: 900 (l) * 610 (w) * 19 (h) mm
Material	: TPE
Available in	: Black
Packing information	: 950 (l) * 650 (w) * 30 (h) mm, 1,5 kg

Drawer | SKU: PERS.DR

Less and less documentation material is needed in a digital world. That's why this personal drawer is the perfect solution. It is equipped with a pen tray and has a lock to keep your belongings safe while not taking up much space.

Dimensions	: 300 (l) * 390 (w) * 90 (h) mm
Including	: 2 keys
Available in	: Aluminium (RAL 9006)
	: Black (RAL 9005)
	: White (RAL 9010)





Cabinet | SKU: CAB.3

This portable drawer unit is equipped with telescopic slides, a pen tray and a drawer with a lock. For a safe storage of your personal belongings.

Dimensions cabinet	: 580 (w) * 420 (d) * 540 (h) mm
Dimensions drawers	: 560 (w) * 420 (d) * 155 (h) mm
Available	: Aluminium (RAL 9006) : Black (RAL 9005) : White (RAL 9010)

Wing set / SKU: WIN

In order to create a curvy table top, AOKE offers the “wing desk replacement set”.

This set makes it possible to carry a bigger table top (with curve) by increasing the size of one foot and bracket. By adding this additional space a curved table top can be attached to the new frame. Moreover, the support beam will be swapped into a curved support beam to ensure the stability of the office desk.

Note: the standard support beam, one foot and one bracket won't be needed anymore after installing the wing desk set.

Available in	: Aluminium, Anthracite, Black, White
Size of foot	: 1000 mm
Size of bracket	: 900 mm
Size of curved support beam	: 1200 - 1750 mm

suitable for all dual-motor frame except Little and Home.



MONITOR ARMS

We have three different Monitor arms for our high-quality desks. A single spring Arm (AK-MA02S), a DUO spring arm (AK-MA02D) and a flat Manual arm (AK-MA09D) including bracket for Dual option (AK-MA09B).

Single spring / SKU: AK-MA02S

Dual Spring / SKU: AK-MA02D

Suitable monitor size	: 14 – 32 inch
Rotation angle	: 360 degrees
Height adjustable range	: 240mm
Weight capacity	: 2 – 9 Kg
Material	: ABS & Aluminium
Available in	: Aluminium (RAL 9006) : Black (RAL 9005) : White (RAL 9010)
Warranty	: 5 years





Single Manual / SKU: AK-MA09S

Suitable monitor size	: Max. 32 inch
Rotation angle	: 360
Weight capacity	: Max. 9 Kg
Height range	: 18 cm
Material	: ABS & Aluminium
Available in	: Aluminium (RAL 9006) : Black (RAL 9005) : White (RAL 9010)
Warranty	: 5 years

Dual bracket / SKU: K-MA09D

Suitable monitor size	: 2 * 32 inch
Rotation angle	: 360
Weight capacity	: Max. 9 Kg per VESA mount
Height range	: 18 cm
Material	: ABS & Aluminium
Available in	: Aluminium (RAL 9006) : Black (RAL 9005) : White (RAL 9010)
Warranty	: 5 years

■ Suitable for all dual-motor frame except Little and Home

LEG COVERS

These leg covers are suitable to instal on the legs of the frames. They are used to make the workplace look neat and tidy and available for different frames.

Cubic | SKU: AK-ZTPJ-80-SQR

Smart & Flex | SKU: AK-ZTPJ-80-RCT

Meet | SKU: AK-ZTPJ-100-SQR

Duo + | SKU: AK-ZTPJ-166-RCT

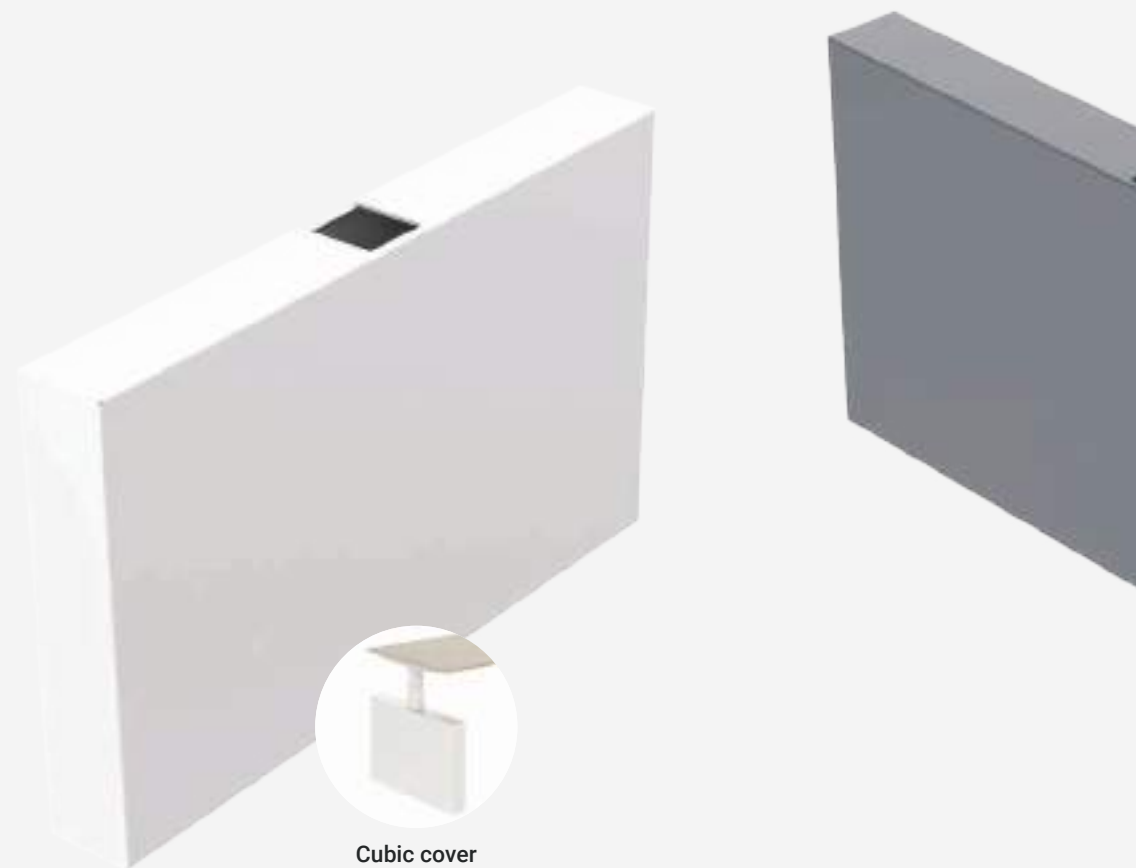

Cubic cover

- Dimensions**
- : AK-ZTPJ-80-SQR : 800 (l) * 95 (w) * 475 (h) mm
 - : AK-ZTPJ-80-RCT : 800 (l) * 95 (w) * 475 (h) mm
 - : AK-ZTPJ-100-SQR : 1000 (l) * 95 (w) * 475 (h) mm
 - : AK-ZTPJ-166-RCT : 1660 (l) * 95 (w) * 475 (h) mm
- Available in**
- : Aluminium (RAL 9006)
 - : Black (RAL 9005)
 - : White (RAL 9010)



Meet cover

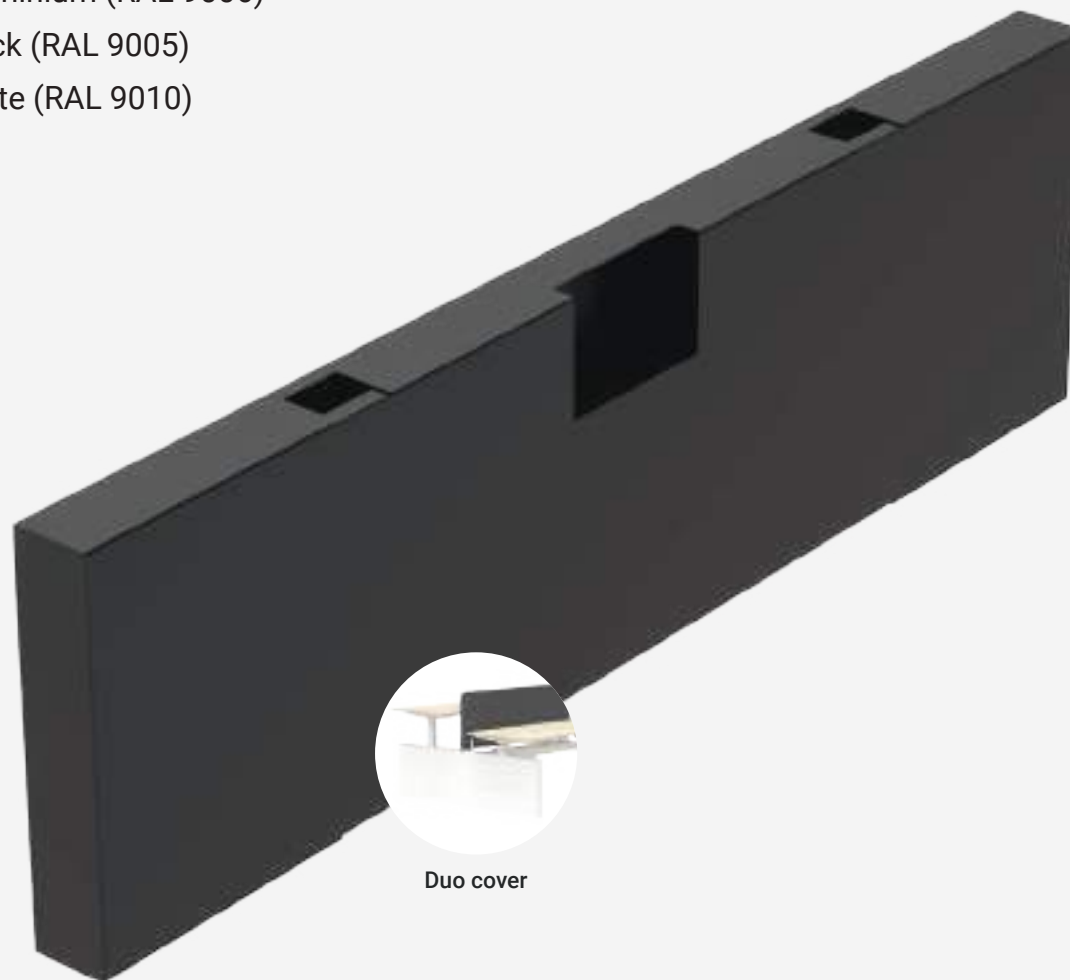

Duo cover

HANDSETS

TDH18P

Maximum available buttons : 5
Display : 3-digit display shows height of the desk
Colour : Black
Memory functionality : 3 settings

- » Compatible with the TWD1 (Bluetooth adapter).*
- » With 2 USB charging ports.
- » 3-digit display shows height of the desk

* The desk can be controlled by Bluetooth when using the TWD1 (Bluetooth adapter).



TH14

Maximum available buttons : 2
Colour : Black



TDH6

Maximum available buttons	: 7
Display	: 3-digit display shows height of the desk
Colour	: Black
Memory functionality	: 4 settings

WP-H01

Maximum available buttons	: 7
Display	: 3-digit display shows height of the desk
Colour	: Black
Memory functionality	: 4 settings

» With 1 USB charging port.



DESK RISERS

Enhance / SKU: AK-MR-P13-2

Type of desk riser	: Pneumatic desk riser
Height range for top	: 55 – 408 mm
Max. lifting capacity	: 8 Kg
Warranty period	: 2

Packaging information

Dimensions	: 700 (l) * 530 (w) * 120 (h) mm
Net weight	: 12 Kg
Gross weight	: 13 Kg





Advance / SKU: AK-MR-E03S

Type of desk riser : Electric desk riser
 Height range :
 Top : 150 – 550 mm
 Keyboard : 20 – 420 mm

Max. lifting capacity : 20 Kg
 Speed : 15 mm/s
 Input : 100 – 240V
 Noise level : < 50 dB
 Warranty period : 5 years

Dimensions : 990 (l) * 650 (w) * 250 (h) mm
 Net weight : 27 Kg
 Gross weight : 28,6 Kg

Raise / SKU: AK-MS03

Raise
 Type of desk riser : Monitor raiser
 Sizes : 560 (l) * 210 (w) * 80 (h) mm
 Max. capacity : 20 Kg
 Glass type : tempered
 Warranty period : 2 years

Dimensions : 630 (l) * 250 (w) * 50 (h) mm
 Gross weight : 28,6 Kg
 Units per Carton : 5





SEATING SERIES

To provide comfort during your workday AOKE Europe has carefully selected a range of high-quality chairs. In our assortment we consider the ergonomic posture of your office employees as we value health and comfort. To make your office experience complete we would like to introduce the following assortment;

Basic	SKU: AK-C01
Air	SKU: AK-C02
Comfy	SKU: AK-C03
Balance	SKU: AK-SH01

Basic**SKU: AK-C01**

By combining ergonomics, design and exclusive quality, The Basic creates a seating experience of both luxury and simplicity. It can be integrated into any room concept. In addition, this chair is EN-1335 certified.



- » Ergonomic office chair according to EN-1335 certificate;
- » Equipped with a synchronous mechanism;
- » Can be locked in 4 positions with kickback protection;
- » Depth adjustment trough sliding the seat;
- » Adjustable body weight;
- » 3D-adjustable armrest with soft pad;
- » Height-adjustable backrest;
- » Plastic design footstool;
- » Multifunctional wheels 60 mm;
- » Upholstery with 100,000 Martindale;
- » 5-year warranty.

Packaging information

Dimensions	: 730 (l) * 380 (w) * 640 (h) mm
Gross weight	: 19 Kg
Units per box	: 1



For assembly videos and instructions

SCAN ME

Air

SKU: AK-C02

A modern office chair with practical adjustment options, an elegant design, as well as ergonomic certified. The sophisticated combination of breathable mesh fabric and hard-wearing material ensures maximum comfort and a pleasant sitting climate at all times.



- » Ergonomic office chair according to EN-1335 certificate;
- » Equipped with a synchronous mechanism;
- » Can be locked in 4 positions;
- » Depth adjustment trough sliding the seat;
- » Adjustable body weight;
- » 3D-adjustable armrest with soft pad;
- » The backside is made of black mesh;
- » Plastic design footstool;
- » Multifunctional wheels 60 mm;
- » Upholstery with 100,000 Martindale;
- » 5-year warranty.

Packaging information

Dimensions	: 700 (l) * 320 (w) * 650 (h) mm
Gross weight	: 19 Kg
Units per box	: 1

For assembly videos and instructions



SCAN ME

Comfy **SKU: AK-C03**

The ergonomic office chair Comfy with Donati base, is manufactured with quality materials and has a superior finish. The Comfy offers a high level seating comfort thanks to its individual adjustment options such as seat depth, height, sit-angle, and the 4-way adjustable synchronous mechanism.



- » Ergonomic office chair according to EN-1335 certificate;
- » Donati mechanism (4 positions with synchronous adjustment);
- » Can be locked in 4 positions;
- » Depth adjustment trough sliding the seat;
- » Adjustable seat angle;
- » Flexible height-adjustable backrest;
- » 4D-adjustable armrest;
- » Multifunctional wheels 60 mm;
- » Upholstery with 130,000 Martindale;
- » Suitable for up to 120 kg;
- » 5-year warranty.

Packaging information

Dimensions	: 760 (l) * 400 (w) * 650 (h) mm
Gross weight	: 21 Kg
Units per box	: 1

[For assembly videos and instructions](#)

SCAN ME

Balance SKU: AK-SH01

The Sit-stand stool "Balance" is a balance stool with a preformed ergonomic seat and is especially suitable for sit/stand work. The seat is height adjustable by using a gas spring. The dish foot creates imbalances and promotes the body to sit upright.



- » Easy to adjust the height of the stool;
- » The stool is fitted with foam; 330 mm diameter
- » 360° swivel: the stool can be rotated 360 degrees;
- » Portability: the handle makes it easy to move the stool;
- » The stool is provided with a gas spring; reach 585 mm - 825 mm
- » 5-year warranty.

Packaging information

Dimensions	: 490 (l) * 420 (w) * 280 (h) mm
Gross weight	: 9,8 Kg
Units per box	: 1



For assembly videos and instructions

SCAN ME



PRODUCT SPECIFICATIONS

PRODUCTS	T-Motion						
	Single motor	Dual motor					
	Easy Up	Smart	Cubic	Little	Prestige	Circle	Home
Product information							
Leg orientation	Square	Rectangular	Square	Square	Square	Round	Rectangular
Adjustable range Height mm.	690 - 1150	625 - 1275	625 - 1275	690 - 1150	625 - 1275	625 - 1275	710 - 1190
Adjustable range Frame size mm.	1075 - 1720	1075 - 1800	1075 - 1800	700 - 1100	1075 - 1800	1075 - 1800	1145 x 588
Table top brackets Length in mm.	600	600	600	500	600	600	275
Foot Length in mm.	700	700	700	600	700	700	600
Lifting capacity in Kg.	100	120	120	120	120	120	60
Max . Speed in mm/s	25	40	40	40	40	40	40
Noise level in dB.	50	<45	<45	<40	<45	<40	<45
Electricity input	110 - 230V	110 - 230V	110 - 230V	110 - 230V	110 - 230V	110 - 230V	111 - 230V
Warranty period in Years	5	5	5	5	5	5	2
Bluetooth	Optional	Optional	Optional	Yes	Yes	Optional	No
Motor	T-Motion	T-motion	T-motion	AOKE	T-motion	T-motion	AOKE
Anti-collision type	X	T-touch (gyroscope)	T-touch (gyroscope)	AOKE (gyroscope)	T-touch (gyroscope)	T-touch (gyroscope)	AOKE (gyroscope)
Available colours	B/W/A	B/W/A	B/W/A	B/W/A	B/W/A	B/W/A	B/W
Control boxes	TC11	TC15S	TC15S	Integrated	TC15S	TC15S	Integrated
Control box information							
Built-in transformer	SMPS	SMPS	SMPS		SMPS	SMPS	
Standby power cons.	0.1W	0.1W	0.1W	Integrated into handset	0.1W	0.1W	Integrated into handset
Maximum output	32V DC, 2.5A	32V DC, 2.5A	32V DC, 2.5A		32V DC, 2.5A	32V DC, 2.5A	
Packing Information							
Dimensions in cm.							
Length	104.5	104.5	104.5	93	104.5	104.5	2 boxes - sizes in table 2
Width	31	31	31	30	31	31	
Height	19	19	19	20	19	19	
Net weight in Kg.	27.6	29.5	30.5	21.6	32.5	28.5	38
Gross weight in Kg.	29	31.5	31.5	23.6	34.5	30	
Quantity per pallet	44	44	44	48	44	44	1/2:42
							2/2:34
Container Quantities							
20 GP / Sets	288	320	320	X	320	320	X
40 HC / Sets	792	760	760	864	760	760	316

Bosch							Manual	
Triple motor			Quadruple motor	2 * Dual motor	Dual motor	2 * Dual motor		
Edge	Trio	Meet	Block	Smart Duo	Flex	Flex Duo	Handle	Handle Duo
Square	Square	Square	Square	Rectangular	Rectangular	Rectangular	Rectangular	Rectangular
625 - 1275	625 - 1275	625 - 1275	625 - 1275	625 - 1275	625 - 1275	625 - 1275	680 - 1130	680 - 1130
1075 - 1800	1100 - 1700 *2	2000 - 3000	860 - 1400	1075 - 1800	1075 - 1800	1075 - 1800	1150 - 1800	1150 - 1800
2*600 + 1*500	600	900	2 * 1000	600	600	600	600	600
2*700 + 1*500	700	900	2 * 1000	90	700	90	90	90
150	150	150	200	120 per side	80	80 per side	80	80 per side
38	38	38	40	40	40	40	8/turn	8/turn
50	50	50	50	<45	<45	<45	x	x
110 - 230V	110 - 230V	110 - 230V	110 - 230V	110 - 230V	110 - 230V	110 - 230V	x	x
5	5	5	5	5	2	2	5	5
Optional	Optional	Optional	Optional	Optional	n.a.	n.a.	x	x
T-motion	T-motion	T-motion	T-motion	T-motion	Bosch	Bosch	x	x
T-touch (gyroscope)	T-touch (gyroscope)	T-touch (gyroscope)	T-touch (gyroscope)	T-touch (gyroscope)	gyroscope	gyroscope	x	x
B/W/A	B/W/A	B/W/A	B/W/A	B/W/A	B/W/A	B/W/A	B/W/A	B/W/A
T16P	T16P	T16P	2*TC15S	2*TC15S	WP-CB01-001	2*WP-CB01-001	x	x
SMPS	SMPS	SMPS	SMPS	SMPS	SMPS	SMPS	x	x
0.1W	0.1W	0.1W	0.1W	0.1W	0.1W	0.1W	x	x
32V DC, 4A	32V DC, 4A	32V DC, 4A	32V DC, 2.5A	32V DC, 2.5A	32V DC, 4A	32V DC, 4A	x	x
					104.5	2 till 4 boxes -	113.5	3 boxes - sizes in table 2
2 boxes - sizes in table 2					31	sizes in table 2	32	
					19		20	
45.8	45.8	52.5	30.5	62.8	30	66	24.5	42
49.8	49.8	56	60	68.1	32.7	66.2	26.5	61.2
1/2 : 42(leg)	1/2 : 42(leg)	30	30	1/3:24(leg)	44	27	44	1/3: 40 (leg)
2/2:54	2/2:54			2/3:60				2/3: 52
				3/3:80(cable tray)				3/3: 80(cable tray)
200	140	140	320	150	320	120	288	150
500	336	336	720	340	760	270	792	350
42				72				80

Products	T-Motion						Bosch	Manual
	Home	Edge	Trio	Meet	Block	Smart Duo	Flex Duo	Handle Duo
Packing Information								
Box 1	Dimensions in cm.							
Length	84	83.5	875	875	1150	101	107.5	68.5
Width	43	38.5	475	475	320	24	37.5	41.5
Height	15	15	140	140	220	12	24	22
Box 2								
Length	126	111	1075	1055	1150	78.5	107.5	112
Width	69	19.5	395	365	320	51.5	37.5	18.5
Height	13	25	195	195	220	17.5	24	24
Box 3							Cable	
Length						105.5	96.5	101
Width						19.5	22	24
Height						21.5	10	12
Box 4							Panel	
Length							24	
Width							15	
Height							7	



For assembly videos and instructions



SCAN ME

PRODUCT DIMENSIONS

EASY-UP

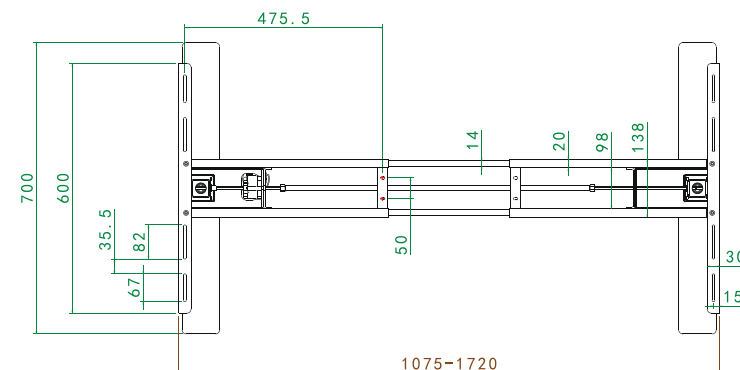
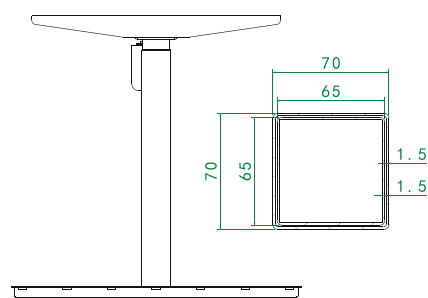
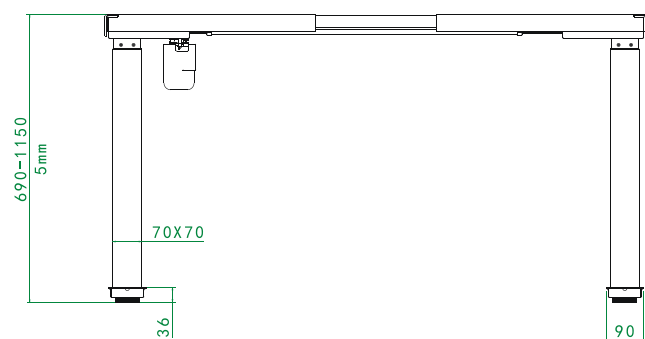

SMART

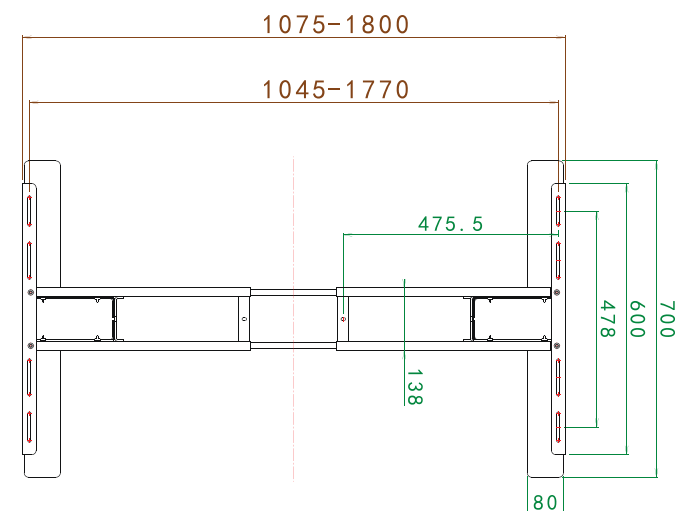
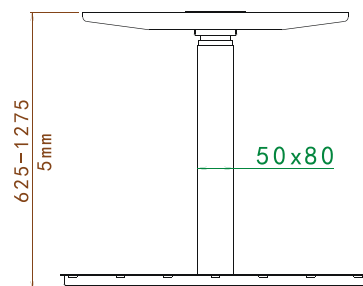
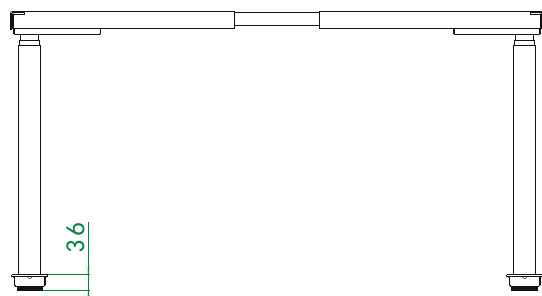

CUBIC

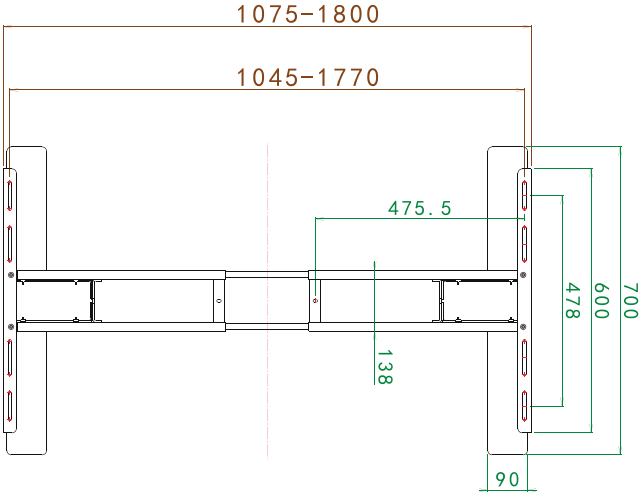
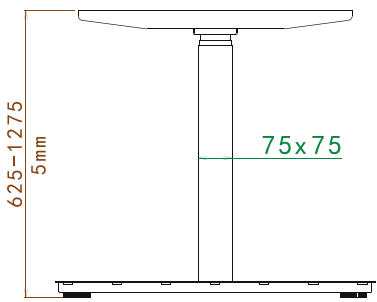
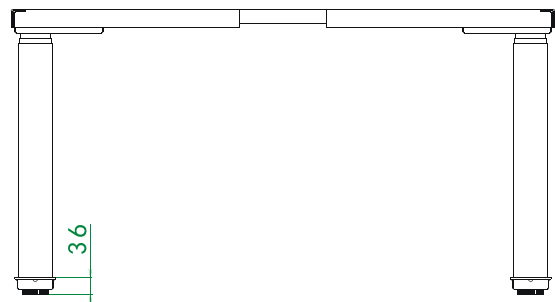

PRESTIGE

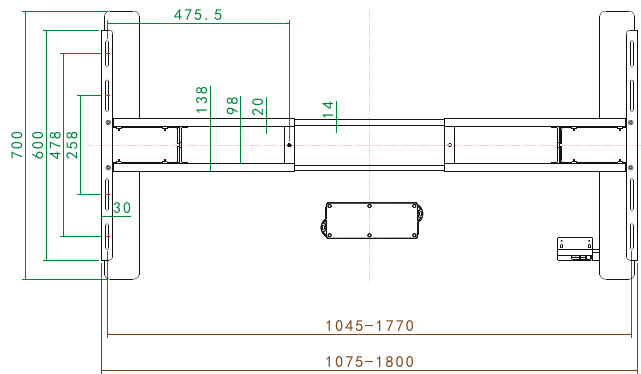
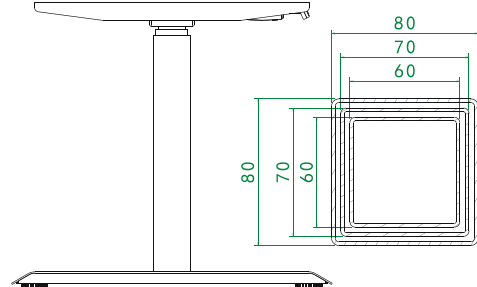
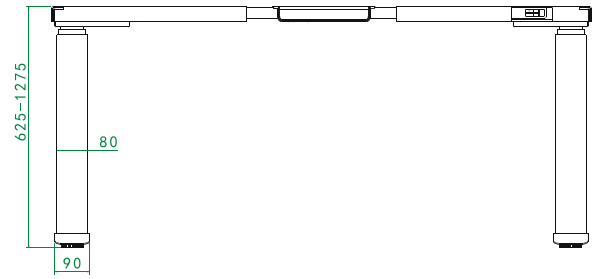

FLEX

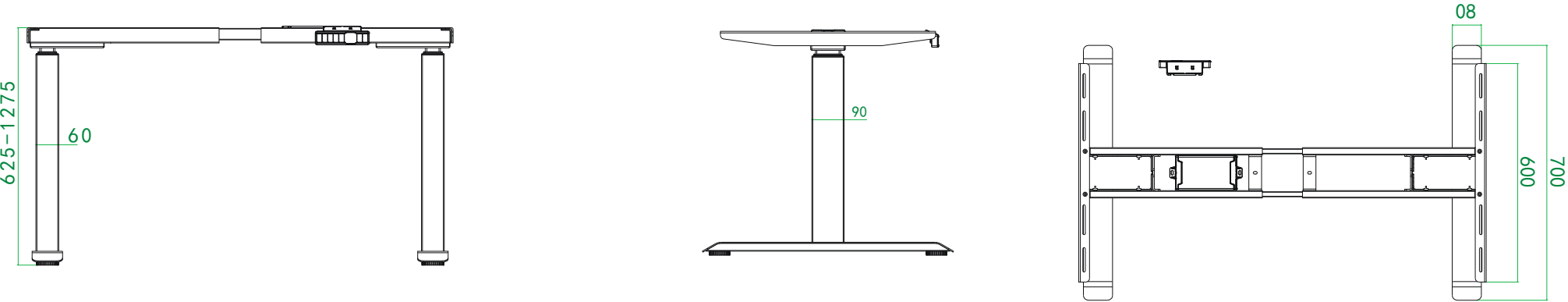

CIRCLE

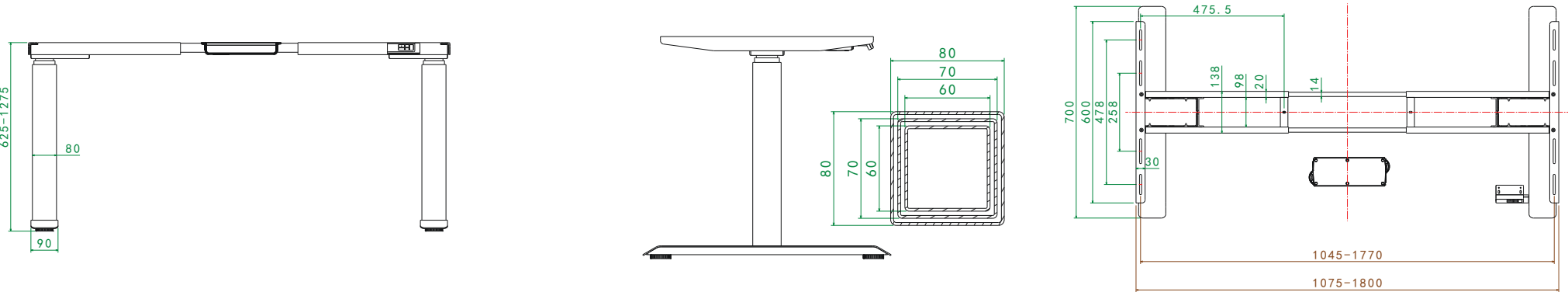

SMART DUO

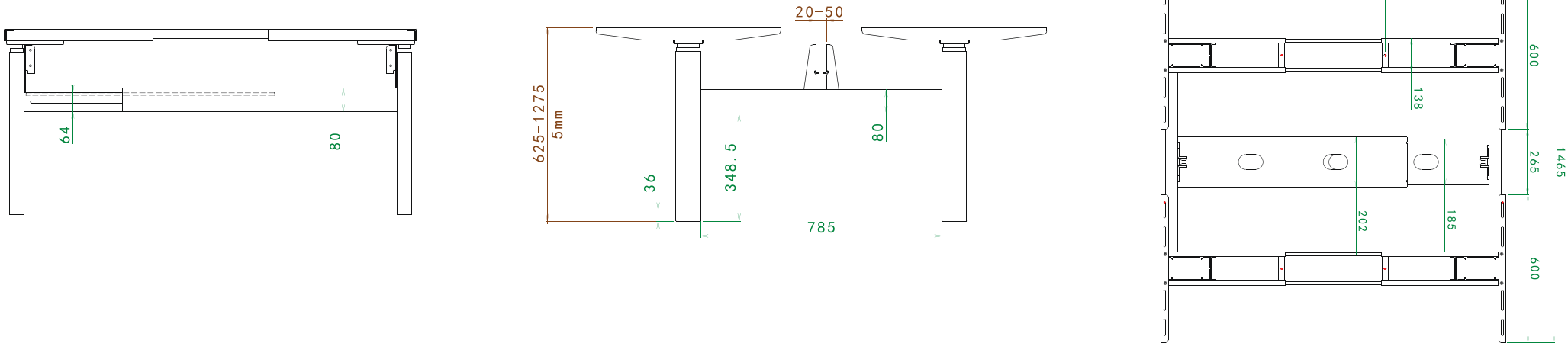

FLEX DUO

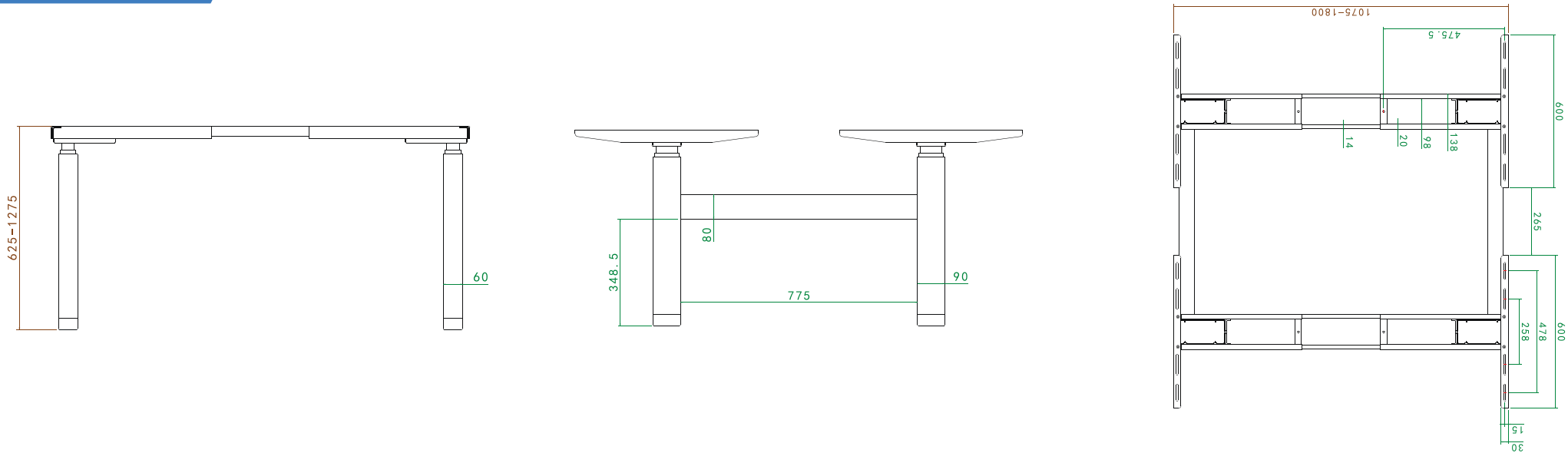

EDGE

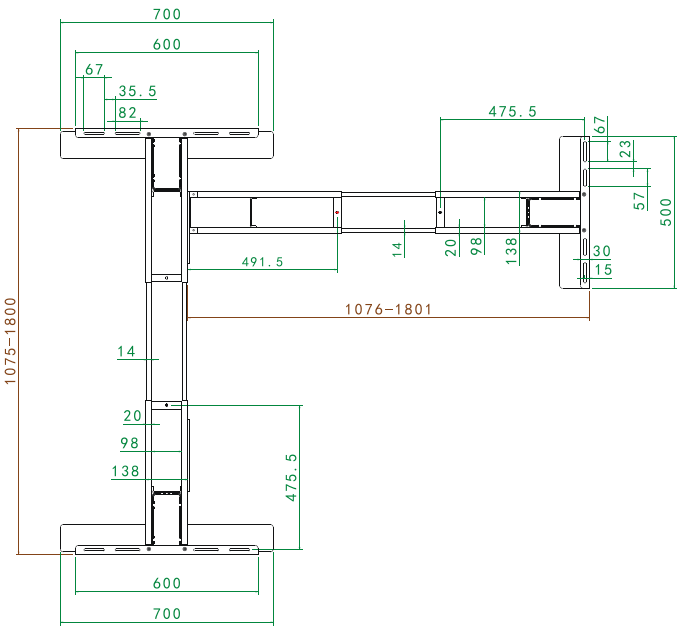
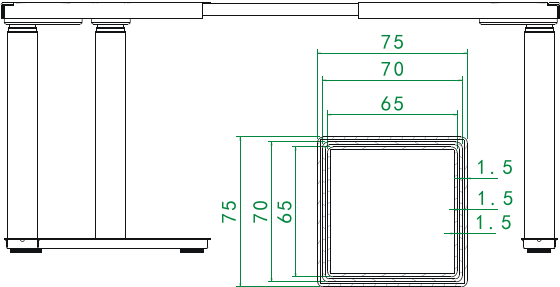
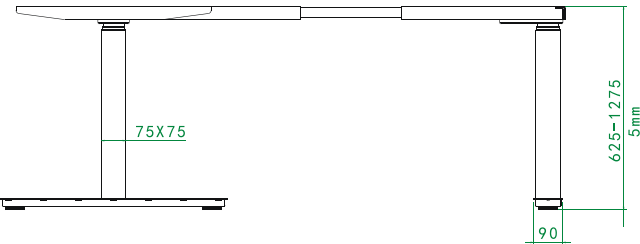

TRIO

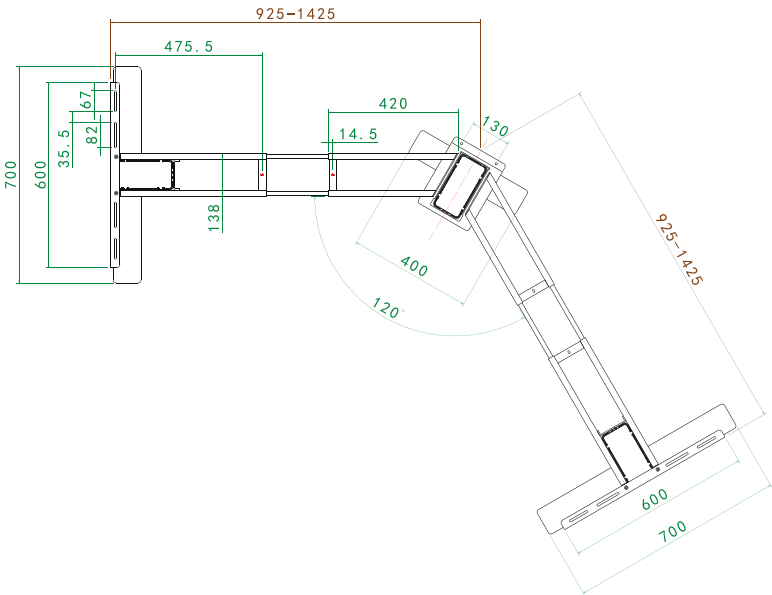
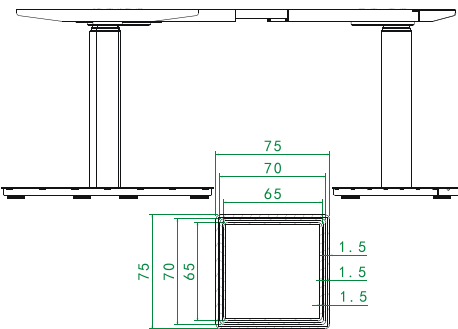
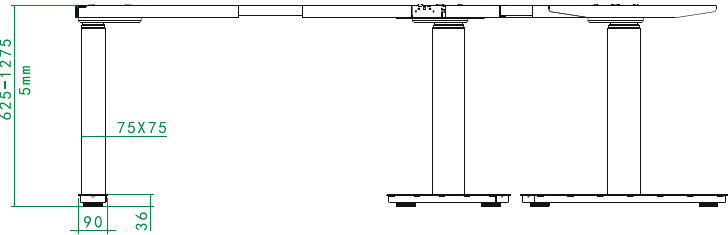

MEET

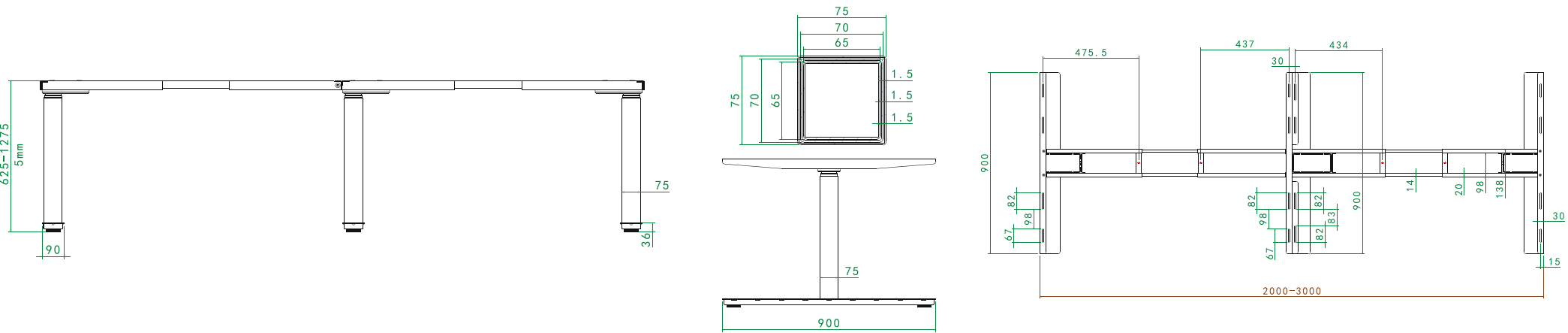

BLOCK

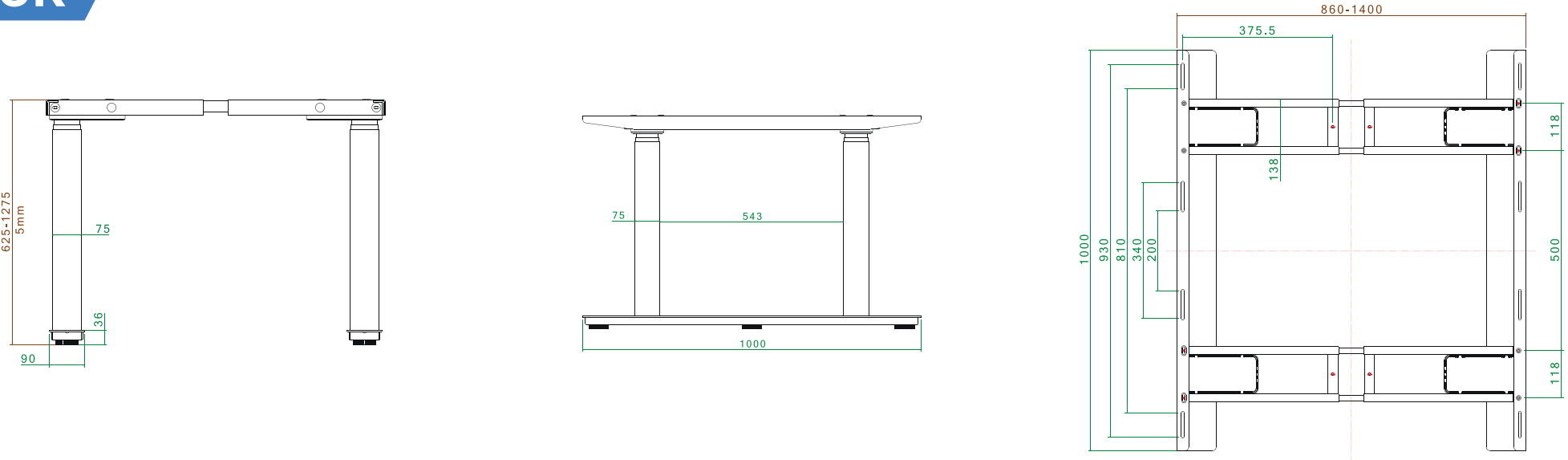

HANDLE

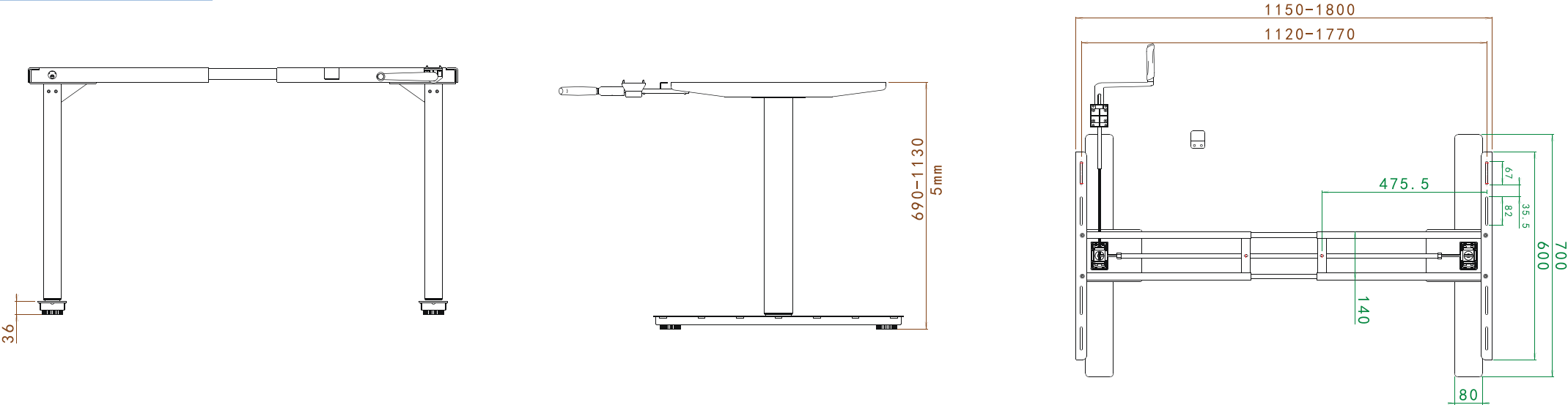

HANDLE DUO

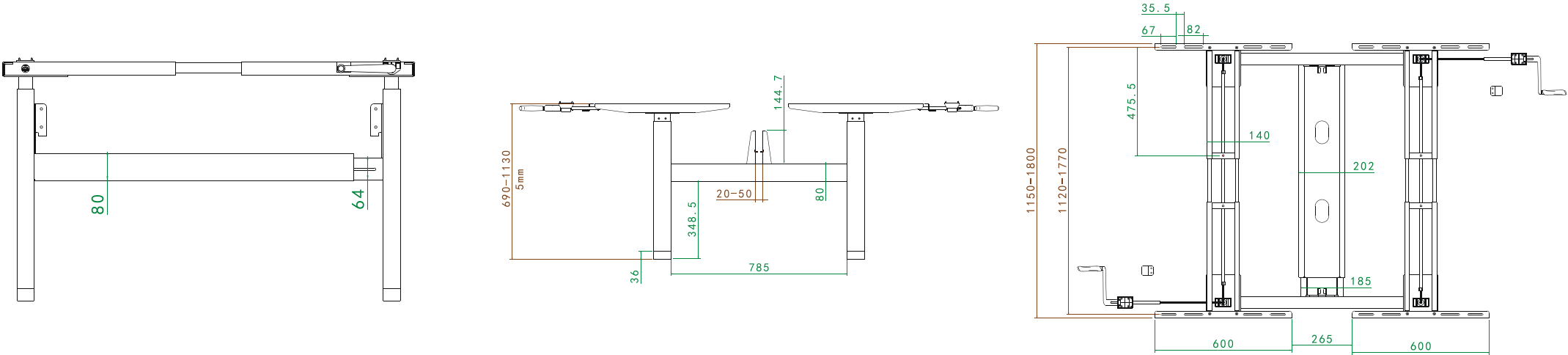

HOME

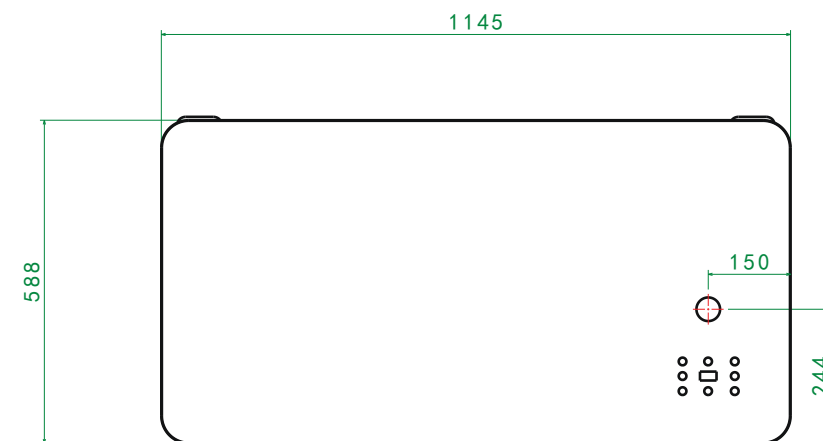
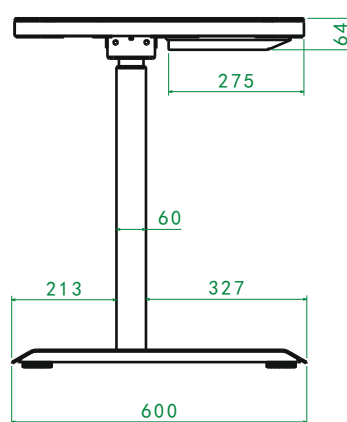
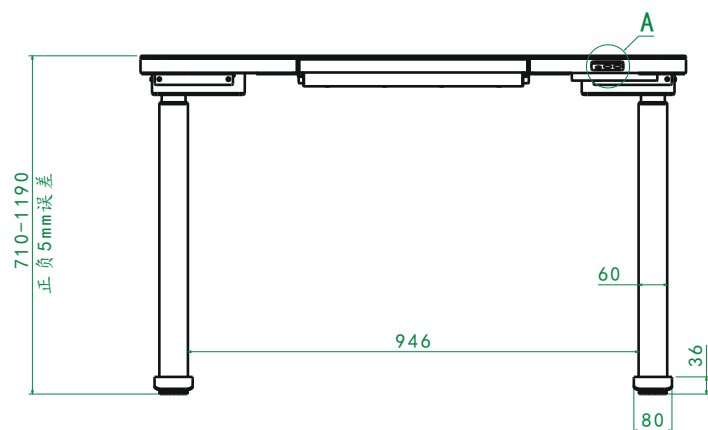

LITTLE

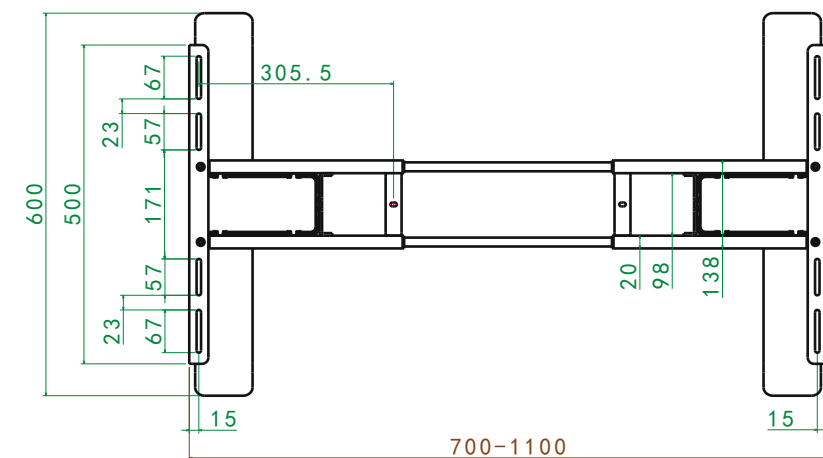
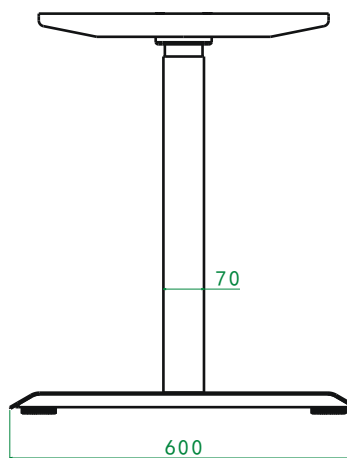
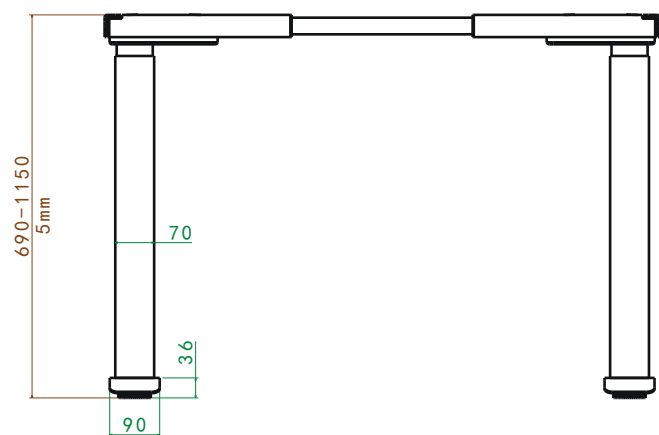

FIX

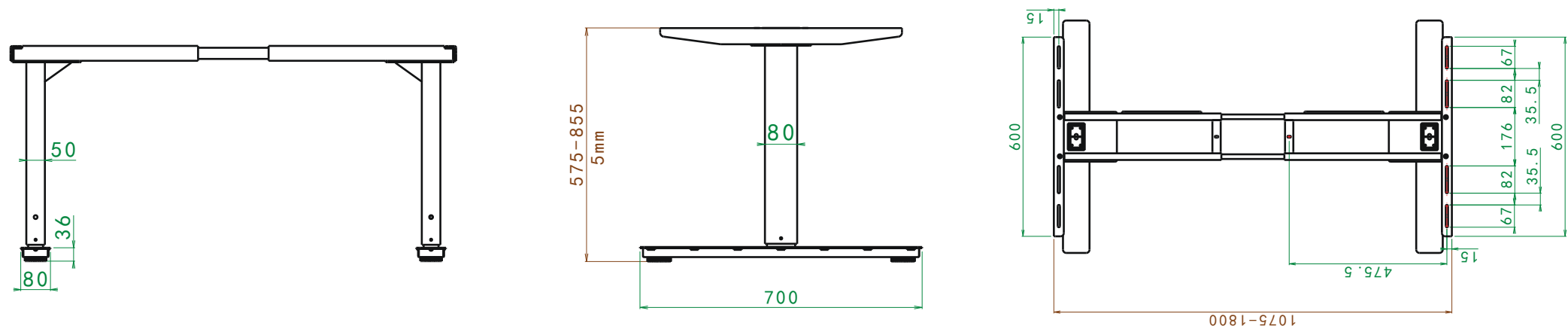

FIX 90

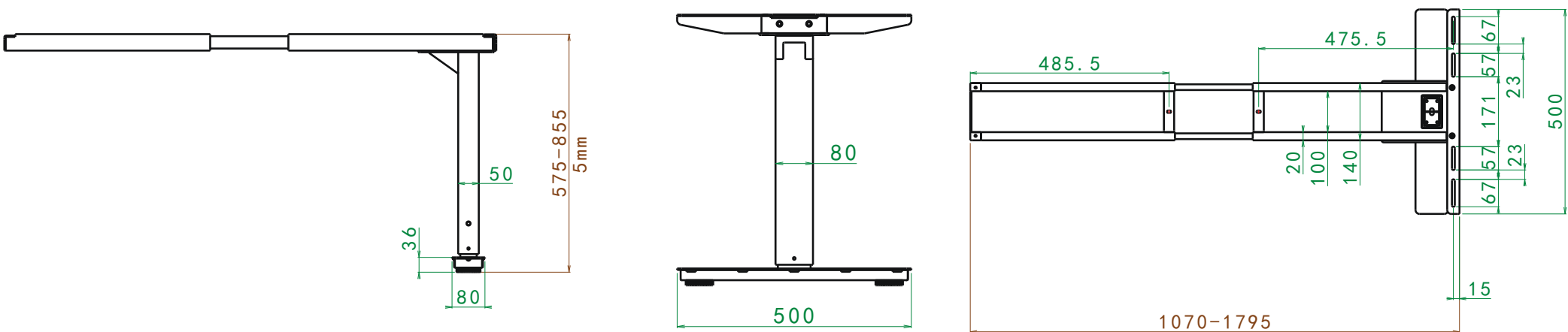



➤ AOKE FACTORY

No.160 North Huanzhen Road, Science and Technology Park Jiangshan Town, Ningbo City

+86-574-88193751 - +86-574-88193756

+86-574-88193752

www.nbaoke.com - www.aokefurniture.com

➤ AOKE OFFICE

Room 602 Li Shi Business Building, No.82 Taiyuxiang Yinzhou Ningbo 315100 Zhejiang China

+86-574-88193751

+86-574-88193752

sales_01@aokefurniture.com

www.nbaoke.com - www.aokefurniture.com

➤ AOKE SOUTHEAST ASIA CO., LTD.

15/46 Moo.18 Lam Luk Ka Rd., Khukhot, Lumlukka, Pathumthani Thailand 12130

+66-2035 7029

sale@aoke-southeastasia.com

www.aokefurniture.com

➤ AOKE EUROPE B.V.

Edisonweg 10, 6101 XJ Echt, The Netherlands

+31-475 72 98 90

sales@aoke-europe.com

www.aoke-europe.com